



FITTING INSTRUCTIONS FOR LP0222BK LICENCE PLATE BRACKET
SUZUKI GSX-R1000 '17-



THIS KIT CONTAINS THE ITEMS PICTURED AND LABELLED BELOW.
DO NOT PROCEED UNTIL YOU ARE SURE ALL PARTS ARE PRESENT.

Please note that the way the kit is packed does not necessarily represent the way of mounting to the bike.

THE PARTS SHOWN MAY BE REPRESENTATIVE ONLY (FOR CLARITY OF INSTRUCTIONS ONLY).

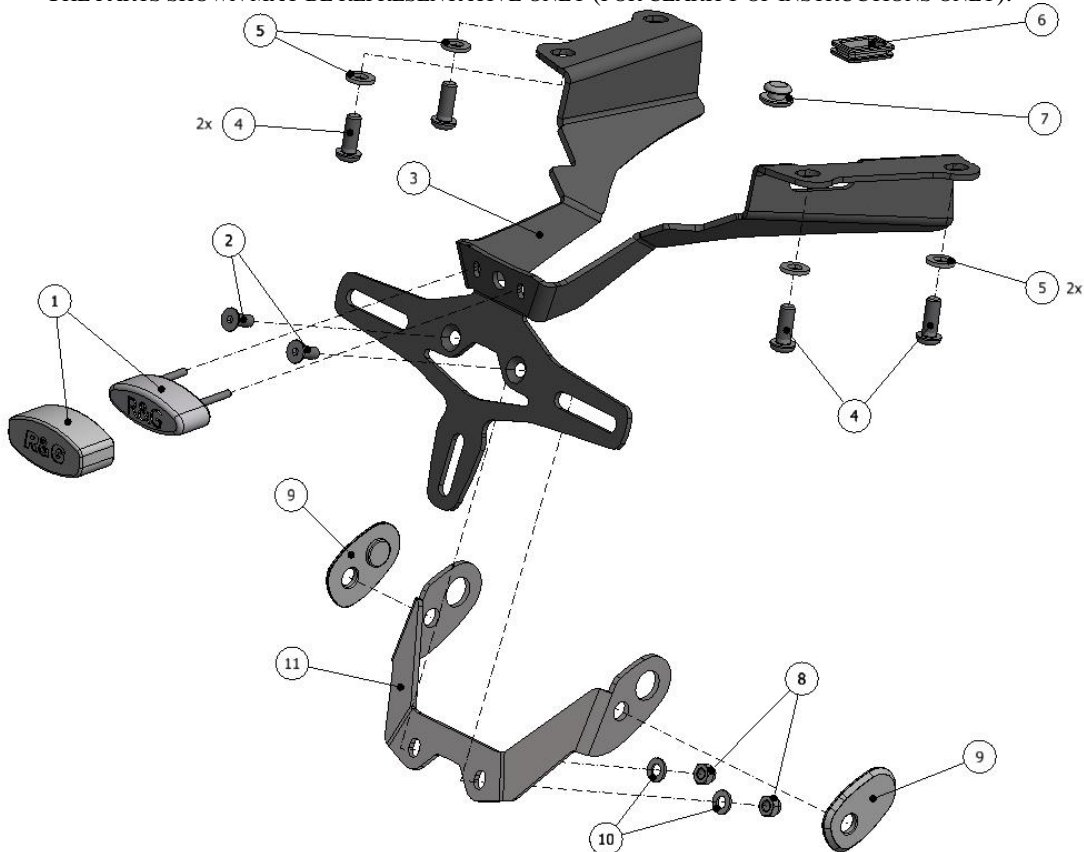

R&G Racing

Unit 1, Shelley's Lane, East Worldham, Alton, Hampshire, GU34 3AQ
Tel: +44 (0)1420 89007 Fax: +44 (0)1420 87301 www.rg-racing.com Email: info@rg-racing.com

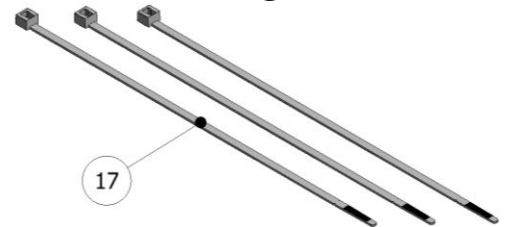
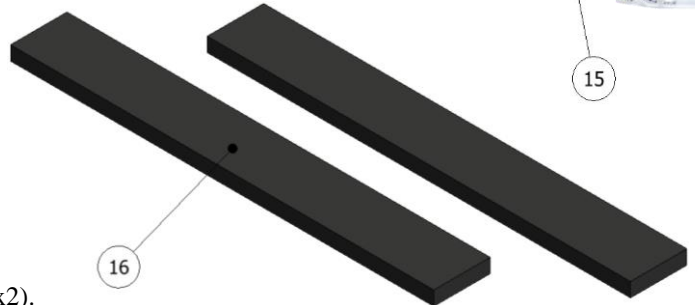
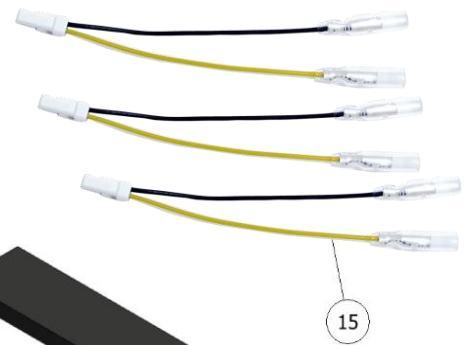
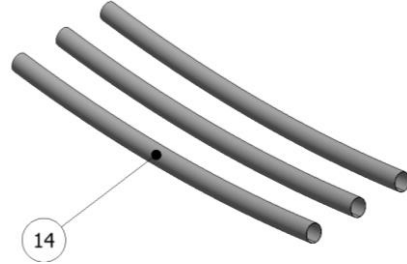
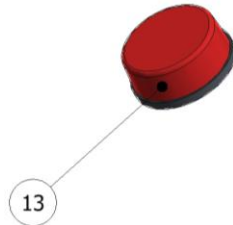
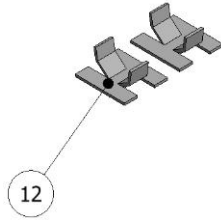

LEGEND

- ITEM 1 = LICENCE PLATE ILLUMINATOR & SHROUD (LA0002) (x1).
- ITEM 2 = M5 x 12mm LONG COUNTERSUNK BOLTS (x2).
- ITEM 3 = LICENCE PLATE BRACKET (TB0222 Part 1) (x1).
- ITEM 4 = M6 x 16mm LONG BUTTON HEAD BOLTS (x4).
- ITEM 5 = M6 WASHERS (x3).
- ITEM 6 = LARGE RUBBER BUNG (RB0007) (x1).
- ITEM 7 = SMALL RUBBER BUNG (RB-80-30-00) (x1).
- ITEM 8 = M5 NYLOC NUTS (x2).
- ITEM 9 = MINI INDICATOR ADAPTORS (I0051) (x4).
- ITEM 10 = M5 WASHERS (x2).
- ITEM 11 = INDICATOR BRACKET (TB0222 Part 2) (x1)
- ITEM 12 = SELF-ADHESIVE CABLE CLIPS (x2).
- ITEM 13 = REFLECTOR (x1).
- ITEM 14 = 150mm LENGTH OF HEATSHRINK (x3).
- ITEM 15 = WIRING CONNECTORS (CON0014) (x3).
- ITEM 16 = 50mm LENGTH OF SELF-ADHESIVE FOAM (x2).
- ITEM 17 = 2.5mm CABLE TIES (x3).

Please note that in cases where kits are packed with rubber washers holding the components onto the bolt – *the rubber washers should be thrown away!*

TOOLS REQUIRED

- Set of metric Allen keys.
- Set of metric sockets and wrench.
- Long Phillips screwdriver.
 - Cable cutters.

MAXIMUM TORQUE SETTINGS

- M4 Bolt = 8 Nm
- M5 Bolt = 12 Nm
- M6 Bolt = 15 Nm
- M8 Bolt = 20 Nm



Picture 1



Picture 2

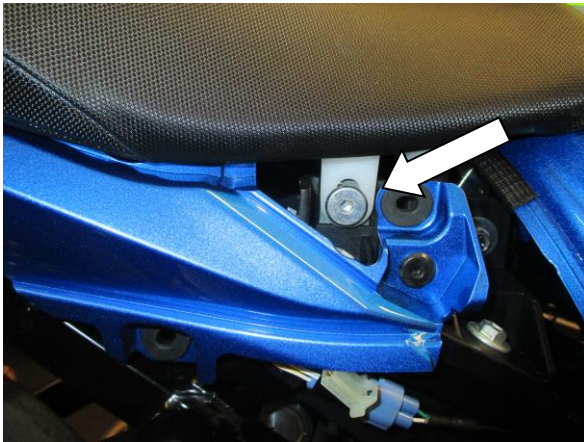

Picture 3

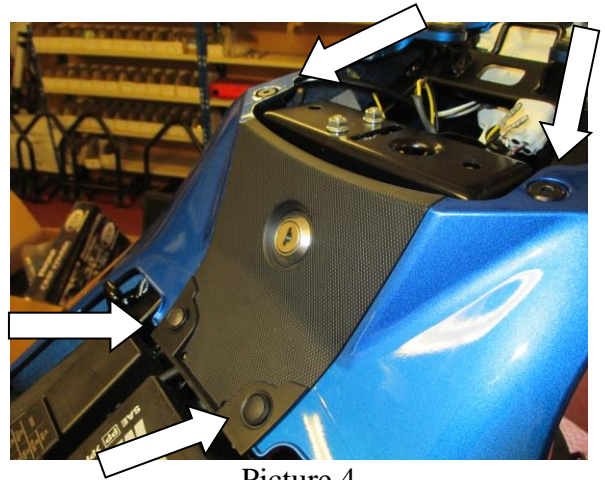

Picture 4



Picture 5

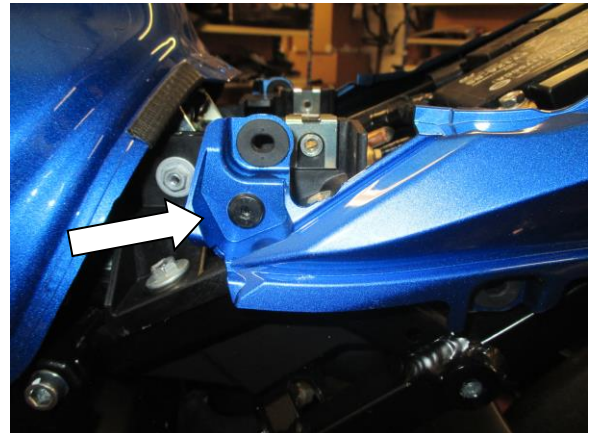

Picture 6



Picture 7



Picture 8



Picture 9

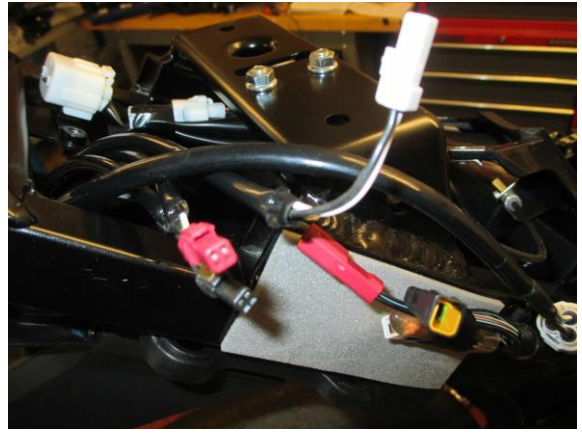

Picture 10



Picture 11



Picture 12



Picture 13



Picture 14



Picture 15



Picture 16



Picture 17



Picture 18



Picture 19



Picture 20



Picture 21



Picture 22

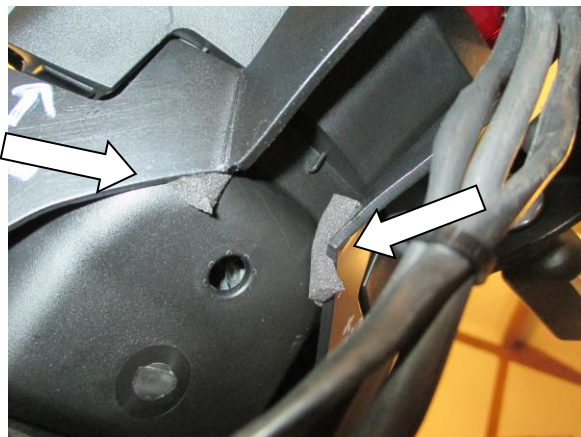

Picture 23

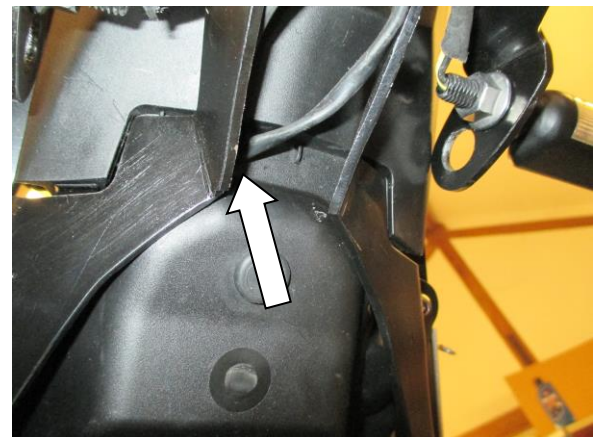

Picture 24



Picture 25



Picture 26

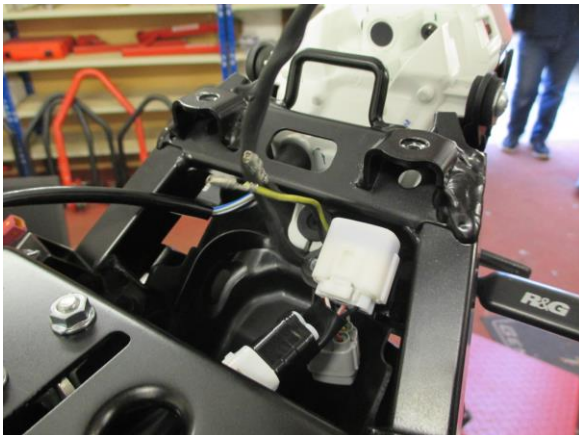

Picture 27

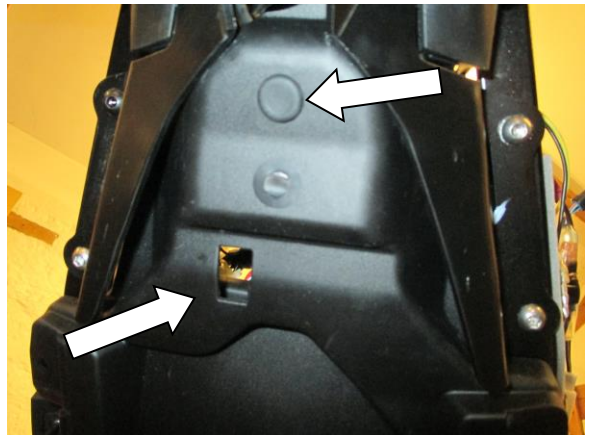

Picture 28



Picture 29



Picture 30



FITTING INSTRUCTIONS

- To fit the R&G tail tidy, remove the pillion seat using the key.
- Remove the two side infill panels from both sides of the bike by removing the bolt that is arrowed in picture 1 and pulling off the rubber mount at the rear, as shown in pictures 1 & 2.
- Remove the riders seat by removing the bolt that secures it in place on both sides of the bike. The right-side bolt is arrowed in picture 3.
- To remove the tail unit, start by removing the two push rivets and two bolts that are arrowed in picture 4.
- Remove the two hex headed bolts that secure the top of the tail unit to the subframe, as shown in picture 5.
- Remove the bolt at the front of the tail unit on both sides of the bike. The left side bolt is arrowed in picture 6.
- Remove the four push rivets that are located on the underside of the tail unit, as shown in picture 7.
- The tail unit can now be removed. Pull the two sides out of the rubber mounts, as shown in picture 8, then slide the entire unit rearwards. The black centre panel with the lock will need to be released whilst doing this and the rear of the bodywork is located to the tail light with flexible plastic tabs. The tail unit may need to be spread wider slightly whilst sliding rearwards, as shown in picture 9.
- Disconnect the three wiring connectors (black, red and white) on the right side of the rear subframe, as shown in picture 10.
- Remove the four bolts on the underside of the OEM licence plate bracket that secure it to the rear subframe, as shown in picture 11. Support the licence plate bracket whilst removing the final Phillips headed bolt that secures the bottom of the tail light to the black plastic. This is in the position of the arrow in picture 12 and can be seen in picture 13. Once removed, feed the wiring out and the OEM licence plate bracket can be removed from the bike.
- Take the licence plate bracket (item 3 – TB0222 Part 1) and fit the R&G licence plate illuminator (item 1 – LA0002) to the bracket, as shown in picture 14. Fit one length of heatshrink to the wires, tighten the nuts on the rear and use a small amount of super glue to secure the light shroud in place.
- Offer the indicator bracket (item 11 – TB0222 Part 2) up to the licence plate bracket and fit the two M5 x 12mm long countersunk bolts (item 2) through the two holes on the licence plate bracket and then through the holes in the indicator bracket, before fitting the two M5 washers (item 10) and two M5 nyloc nuts (item 8) to the end of the bolts, before tightening, as shown in pictures 14, 15 & 16.

If fitting Mini Indicators

- To fit the R&G Mini Indicators, fit one length of heatshrink to the wires of each indicator.
- Feed the wiring of either indicator through the hole in one of the mini indicator adaptors (item 9 – I0051), ensuring the raised boss on the adaptors face away from the indicator, as shown in picture 17.
- Feed the indicator wiring through the smaller hole on the indicator bracket, positioning the raised boss on the adaptor within the larger hole, before fitting the indicator nut over the wiring and tighten onto the threaded stalk of the indicator.
- Fit the other indicator the same way in the remaining indicator mount, ensuring the R&G logo is facing upwards, as shown in picture 18.

If fitting OEM Indicators

- Start off by removing the OEM indicators from the OEM licence plate hanger. Remove the four bolts on the underside of the OEM licence plate bracket, as shown in pictures 19 & 20.
- With the cover removed, remove the bolt that secures each indicator in place and feed the wiring out.
- Fit each indicator to the R&G indicator bracket by feeding the indicator wiring through the larger hole on the indicator bracket and position the threaded boss of the indicator through the smaller hole, before fitting the small top hat spacer and lock nut, as shown in pictures 21 & 22.



- Cut two small pieces of the self-adhesive foam supplied (item 16) and apply it to the two surfaces on the tail tidy that are arrowed in pictures 22 & 23.
 - Take the tail tidy assembly and offer it up underneath the tail whilst feeding the three sets of wires up through the small hole that is arrowed in picture 24.
 - Take the four M6 x 16mm long button head bolts (item 4) and four M6 washers (item 5) and fit through the four mounting holes of the tail tidy before tightening into the threaded bosses on the subframe, as shown in pictures 25 & 26.
 - Ensure the wiring is pulled up through the opening as shown in picture 27 and fit any cable ties (item 17) and self-adhesive clips (item 12) to neaten up the wiring on the underside of the tail unit.
 - Fit the two rubber bungs supplied (item 6 & 7) into the remaining two holes on the underside of the tail unit, as arrowed in picture 28.
 - Connect the licence plate illuminator to one of the connectors supplied (item 15 – CON0014), ensuring the bullet connectors connect black to red and yellow to black, before fitting the remaining end of the wiring to the white OEM connector already on the bike.
 - If using the original indicators, reconnect the connectors to those on the main loom.
 - If fitting Mini Indicators, use the remaining two connector wires supplied (item 15 – CON0014) to connect the mini indicators to the main loom as below.
 - If fitting R&G Aero Indicators the yellow wire on the Aero Indicators connects with the black wire on the OEM indicator wiring and the black wire on the Aero Indicators connects with the yellow wire on the OEM indicator wiring. 1x set of RGR0001 resistors (available separately) are required to achieve the correct flash rate.
 - If fitting R&G Mini Indicators with LED's, the black/white wire on the Mini Indicators connects with the black wire on the OEM indicator wiring and the black wire on the Mini Indicators connects with the yellow wire on the OEM indicator wiring. 1x set of RGR0001 resistors (available separately) are required to achieve the correct flash rate.
 - The R&G Mini Indicators with bulbs do not work on this bike.
 - If illumination fails on any light, re-connect the bullet connectors the other way around.
 - Check for the correct operation of all lights.
 - Re-fit the tail unit bodywork by sliding on from the rear, ensuring all the locating tabs around the tail light fit correctly and that the black centre panel with lock is fitted in place and the rubber mounted prongs push into place on both sides, before re-fitting the six push rivets and six bolts to securely fit in place.
 - Re-fit the riders seat, along with the two mounting bolts on either side of the bike.
 - Re-fit the side infill panels along with the bolt on both sides of the bike.
 - Re-fit the pillion seat.
 - Re-fit the licence plate (it may require drilling).
 - Depending on local laws, attach enclosed reflector in an appropriate location.
 - Test the licence plate illuminator and all lights before riding.
- *The tail tidy can also be used without the indicator bracket fitted, for a sleeker look or if fitted with integrated indicators within the tail light. If doing this, simply fit the tail tidy as described above, but leave out the indicator bracket.*

ISSUE 1 24/04/2017 (AR)

Digital copies of these instructions are available to download from www.rg-racing.com

CONSUMER NOTICE

The catalogue description and any exhibition of samples are only broad indications of the Products and R&G may make design changes which do not diminish their performance or visual appeal and supplying them in such state shall conform to the order. The Buyer acknowledges no representation or warranty (other than as to title) has been given or will apply to the Products other than those in R&G's order or confirmation and the Buyer confirms it has chosen the Products as being of merchantable quality and suitable for its particular purposes. Where R&G fits the Products or undertakes other

R&G Racing
Unit 1, Shelley's Lane, East Worldham, Alton, Hampshire, GU34 3AQ
Tel: +44 (0)1420 89007 Fax: +44 (0)1420 87301 www.rg-racing.com Email: info@rg-racing.com



services it shall exercise reasonable skill and care and rectify any fault free of charge unless the workmanship has been disturbed. The Buyer is responsible for ensuring that the warranty on the motorcycle is not affected by the fitting of the Products. On return of any defective Products R&G shall at its option either supply a replacement or refund the purchase money but shall not be liable if the Products have been modified or used or maintained otherwise than in accordance with R&G's or manufacturer's instructions and good engineering practice or if the defect arises from accident or neglect. Other than identified above and subject to R&G not limiting its liability for causing death and personal injury, it shall not be liable for indirect or consequential loss and otherwise its liability shall be limited to the amounts paid by the Buyer for the Products or the fitting or service concerned. These terms do not affect the Buyer's statutory rights.

R&G RACING RETURNS POLICY (NON-FAULTY GOODS)

Returns must be pre-authorized (if not pre-authorized the return will be rejected). Goods may only be returned direct to us if they were purchased direct from us (customer must prove if necessary). Otherwise to be returned to original vendor. Goods must be in re-sellable condition, in the opinion of R&G Racing. All returns are subject to a 25% restocking and handling fee (25% of the gross value exc. P&P – at the prevailing price at time of purchase). The customer must pay any and all carriage charges. No returns of discontinued products, unless within 14 days of purchase. This policy does not affect your statutory rights and does not refer to faulty goods.



NOTICE DE MONTAGE POUR LP0222BK SUPPORT DE PLAQUE
SUZUKI GSX-R1000 '17-



LE KIT CONTIENT LES ARTICLES EXPOSES CI-DESSOUS, VERIFIER QUE TOUTES LES PIECES SOIENT PRESENTES AVANT DE PROCEDER AU MONTAGE.
LA FAÇON DONT LE KIT EST EMBALLE NE CORRESPOND PAS FORCEMENT A LA FAÇON DE MONTER LES PIECES SUR LA MOTO.
LES PARTIES PRESENTEES PEUVENT ETRE UNIQUEMENT REPRESENTATIVES (POUR LA CLARTE DES INSTRUCTIONS UNIQUEMENT).

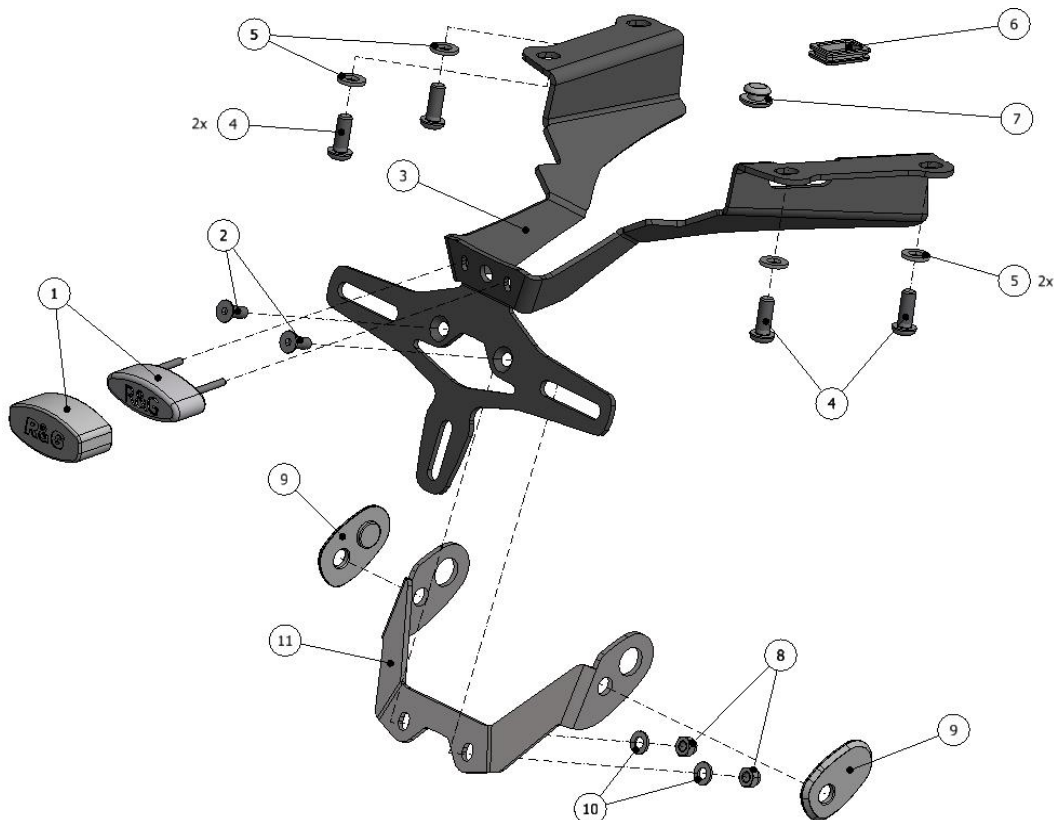

R&G Racing

Unit 1, Shelley's Lane, East Worldham, Alton, Hampshire, GU34 3AQ

Tel: +44 (0)1420 89007 Fax: +44 (0)1420 87301 www.rg-racing.com Email: info@rg-racing.com

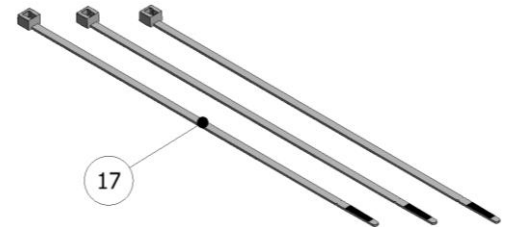
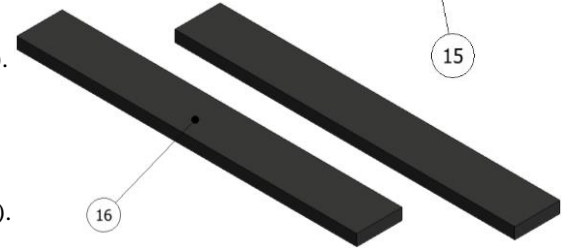
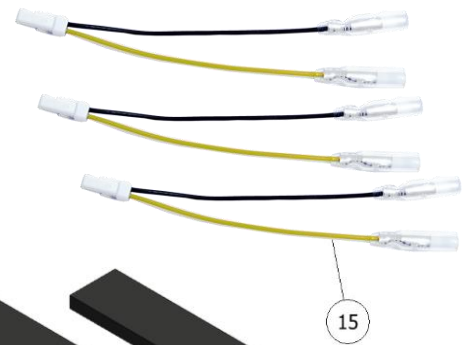
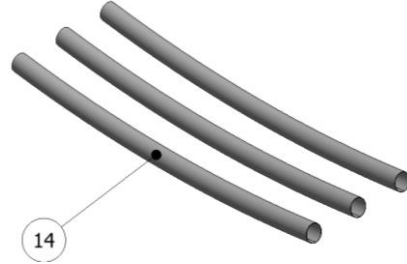
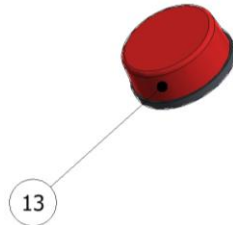
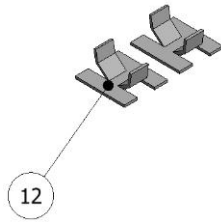

LEGENDE

- ARTICLE 1 = FEU DE PLAQUE & LINCEUL (LA0002) (x1).
- ARTICLE 2 = M5 x 12mm BOULONS (x2).
- ARTICLE 3 = SUPPORT DE PLAQUE (TB0222 Partie 1) (x1).
- ARTICLE 4 = M6 x 16mm BOULONS (x4).
- ARTICLE 5 = M6 RONDELLES (x3).
- ARTICLE 6 = OEILLET EN CAOUTCHOUC (RB0007) (x1).
- ARTICLE 7 = PETIT OEILLET EN CAOUTCHOUC (RB-80-30-00) (x1).
- ARTICLE 8 = M5 ECROUS (x2).
- ARTICLE 9 = ADAPTATEURS DE MINI CLIGNOTANTSS (I0051) (x4).
- ARTICLE 10 = M5 RONDELLES (x2).
- ARTICLE 11 = SUPPORT DE CLIGNOTANT (TB0222 Partie 2) (x1)
- ARTICLE 12 = CLIPS CABLE AUTOCOLLANTS (x2).
- ARTICLE 13 = REFLECTEUR (x1).
- ARTICLE 14 = 150mm LONGUEUR DE THERMO RETRACTABLE (x3).
- ARTICLE 15 = CONNECTEURS DE CABLE (CON0014) (x3).
- ARTICLE 16 = 50mm LONGUEUR DE MOUSSE AUTOCOLLANTE (x2).
- ARTICLE 17 = 2.5mm COLLIERS DE SERRAGE (x3).

Notez que si les kits sont emballés avec des rondelles en caoutchouc servant à tenir les composants, *ces rondelles doivent être jetées!*

OUTILS REQUIS

- Clés Allen.
- Clés à molette et douille.
- Tournevis.
- Coupe câble

Couples de serrage recommandés :

- M4 BOULON = 8Nm
- M5 BOULON = 12Nm
- M6 BOULON = 15Nm
- M8 BOULON = 20Nm



NOTICE DE MONTAGE

- Pour monter le support de plaque R&G, enlever le siège passager en utilisant la clé.
- Enlever les 2 panneaux internes des 2 cotés de la moto en enlevant le boulon indiqué sur la photo 1 et en tirant le support en caoutchouc à l'arrière, voir photos 1 & 2.
- Enlever les sièges en enlevant le boulon qui les fixent en place des 2 cotés de la moto. Le boulon du coté droit est indiqué sur la photo 3.
- Pour enlever l'unité de support de plaque, commencer par enlever les 2 rivets et les 2 boulons indiqués sur la photo 4.
- Enlever les 2 boulons qui fixent le haut de l'unité de support de plaque au sous cadre, voir photo 5.
- Enlever le boulon à l'avant de l'unité de support de plaque des 2 cotés de la moto. Le boulon du coté gauche est indiqué sur la photo 6.
- Enlever les 4 rivets placés au dessous de l'unité de support de plaque, voir photo 7.
- L'unité de support de plaque peut maintenant être enlevée. Tirer les 2 cotés des supports en caoutchouc, voir photo 8, puis glisser l'unité vers l'arrière. Le panneau noir central avec le blocage devra être libéré lors de cette opération et le l'arrière du carénage est placé sur le support de feu de plaque avec des onglets flexibles en plastique. L'unité de support de plaque doit être écarté tout en étant glissé vers l'arrière, voir photo 9.
- Déconnecter les 3 connecteurs de fils (noir, rouge et blanc) du coté droit du sous cadre arrière, voir photo 10.
- Enlever les 4 boulons au dessous du support de plaque d'origine qui le fixent au sous-cadre arrière, voir photo 11. Supporter le support de plaque tout en enlevant le boulon qui fixe le bas du support de feu de plaque au plastique noir. Voir photo 12 et photo 13. Une fois enlevé, passer les fils à l'extérieur et le support de plaque d'origine peut être enlevé de la moto.
- Prendre le support de plaque (article 3 – TB0222 Partie 1) et monter le feu de plaque R&G (article 1 – LA0002) sur le support, voir photo 14. Monter une longueur de mousse thermo rétractable sur les fils, serrer les écrous à l'arrière et utiliser un peu de superglue pour fixer le linéol de feu en place.
- Monter le support de clignotant (article 11 – TB0222 Partie 2) sur le support de plaque et insérer les 2 boulons M5 x 12mm (article 2) dans les 2 trous du support de plaque puis dans les trous du support de clignotant, avant d'insérer les 2 rondelles M5 (article 10) et 2 écrous M5 (article 8) sur l'extrémité des boulons, avant de serrer, voir photos 14, 15 & 16.

Si vous montez des mini clignotants

- Pour monter les minis clignotants R&G, placer une longueur de thermo rétractable sur les fils de chaque clignotant.
- Passer les fils de chaque clignotant dans le trou d'un des 2 adaptateurs de mini clignotants (article 9 – I0051), en veillant à ce que les patrons relevés sur les adaptateurs soient en face l'un de l'autre, voir photo 17.
- Passer les fils de clignotant dans le plus petit trou du support de clignotant, en positionnant le patron relevé sur l'adaptateur avec le trou plus large, avant d'insérer l'écrou de clignotant sur le fil puis serrer sur la tige fileté du clignotant.
- Monter l'autre clignotant de la même façon sur le support clignotant restant, en veillant à ce que le logo R&G soit orienté vers le haut, voir photo 18.

Si vous montez les minis clignotants

- Commencer par enlever les clignotants d'origine du support de plaque d'origine. Enlever les 4 boulons au dessous du support de plaque d'origine, voir photos 19 & 20.
- Une fois le cache enlevé, enlever le boulon qui fixe chaque clignotant en place et passer les fils à l'extérieur.
- Monter chaque clignotant sur le support clignotant R&G en passant le fil de clignotant dans le trou plus large du support de clignotant puis positionner le patron fileté du clignotant dans le petit trou, avant d'insérer la petite entretoise et l'écrou de blocage, voir photos 21 & 22.

R&G Racing

Unit 1, Shelley's Lane, East Worldham, Alton, Hampshire, GU34 3AQ

Tel: +44 (0)1420 89007 Fax: +44 (0)1420 87301 www.rg-racing.com Email: info@rg-racing.com



- Couper 2 morceaux de mousse autocollant fournie (article 16) et appliquez la sur les 2 surfaces du support de plaque, voir photos 22 & 23.
 - Prendre l'assemblage de support de plaque et montez-le au dessous du support tout en passant les 3 fils dans le petit trou présenté sur la photo 24.
 - Prendre les 4 boulons M6 x 16mm (article 4) et 3 rondelles M6 (article 5) et insérez les dans les 4 trous de fixation du support de plaque avant de serrer dans les patrons filetés du sous-cadre, voir photos 25 & 26.
 - Veiller à tirer le fil correctement à travers l'ouverture, voir photo 27 et des colliers de serrage (article 17) ainsi que des clips autocollants (article 12) pour ranger les fils au dessous de l'unité de support de plaque.
 - Insérer les deux bouchons en caoutchouc fournis (article 6 & 7) dans les 2 trous restants au dessous de l'unité de support de plaque, voir photo 28.
 - Connecter le feu de plaque à l'un des connecteurs fournis (article 15 – CON0014), en veillant à ce que les connecteurs soient connectés le noir au rouge et le jaune au noir, avant de monter l'extrémité restante du fil au connecteur blanc d'origine déjà monté sur la moto.
 - Si vous utilisez les clignotants d'origine, reconnecter les connecteurs à ceux du faisceau principal.
 - Si vous monter les mini clignotants, utilisez les 2 connecteurs de fils restants fournis (article 15 – CON0014) pour connecter les mini clignotants au faisceau principal, comme ci-dessous.
 - Si vous montez les minis clignotants R&G latéraux, le fil jaune se connecte avec le fil noir sur le fil de clignotant d'origine et le fil noir sur les clignotants latéraux se connecte avec le fil jaune d'origine. 1x set de résistances RGR0001 (disponible séparément) sont nécessaires pour obtenir le bon niveau d'éclairage.
 - Si vous montez les minis clignotants R&G à LED, le fil noir/blanc sur les minis clignotants se connecte avec le fil noir sur le fil de clignotants d'origine et le fil noir sur le mini clignotant se connecte avec le fil jaune sur les fils de clignotant d'origine. 1x set de résistances RGR0001 (disponible séparément) sont nécessaires pour obtenir le bon niveau d'éclairage.
 - Les minis clignotants R&G à ampoule ne fonctionnent pas sur cette moto.
 - Si l'éclairage échoue sur un des feux, reconnecter les connecteurs dans l'autre sens.
 - Vérifier le bon fonctionnement de tous les feux.
 - Remonter le cache d'unité de support de plaque, en veillant à ce que tous les onglets soient correctement placés autour du feu de plaque, et que le panneau central interne noir avec blocage soit positionné en place et les onglets de fixation en caoutchouc poussent en position les 2 cotés, avant de remonter les six rivets et les 6 boulons pour fixer la position.
 - Remonter les sièges, avec les 2 boulons de fixation de chaque coté de la moto.
 - Remonter les panneaux internes avec le boulon des 2 cotés de la moto.
 - Remonter le siège passager.
 - Remontez la plaque d'immatriculation (Peut nécessiter un perçage).
 - Selon les lois locales, attacher les réflecteurs aux endroits appropriés.
 - Testez le feu de plaque d'immatriculation et tous les autres feux avant de prendre la route.
- *Le support de plaque peut aussi être utilisé sans support de clignotant, pour un look plus élégant si monté avec les clignotants intégrés dans le support de plaque. Si vous optez pour cette solution, montez simplement le support de plaque comme décrits ci-dessus, mais laissez le support de clignotant.*

ISSUE 1 24/04/2017 (AR)

Notice disponible sur www.rg-racing.com



CONSUMER NOTICE

The catalogue description and any exhibition of samples are only broad indications of the Products and R&G may make design changes which do not diminish their performance or visual appeal and supplying them in such state shall conform to the order. The Buyer acknowledges no representation or warranty (other than as to title) has been given or will apply to the Products other than those in R&G's order or confirmation and the Buyer confirms it has chosen the Products as being of merchantable quality and suitable for its particular purposes. Where R&G fits the Products or undertakes other services it shall exercise reasonable skill and care and rectify any fault free of charge unless the workmanship has been disturbed. The Buyer is responsible for ensuring that the warranty on the motorcycle is not affected by the fitting of the Products. On return of any defective Products R&G shall at its option either supply a replacement or refund the purchase money but shall not be liable if the Products have been modified or used or maintained otherwise than in accordance with R&G's or manufacturer's instructions and good engineering practice or if the defect arises from accident or neglect. Other than identified above and subject to R&G not limiting its liability for causing death and personal injury, it shall not be liable for indirect or consequential loss and otherwise its liability shall be limited to the amounts paid by the Buyer for the Products or the fitting or service concerned. These terms do not affect the Buyer's statutory rights.

R&G RACING RETURNS POLICY (NON-FAULTY GOODS)

Returns must be pre-authorized (if not pre-authorized the return will be rejected). Goods may only be returned direct to us if they were purchased direct from us (customer must prove if necessary). Otherwise to be returned to original vendor. Goods must be in re-sellable condition, in the opinion of R&G Racing. All returns are subject to a 25% restocking and handling fee (25% of the gross value exc. P&P – at the prevailing price at time of purchase). The customer must pay any and all carriage charges. No returns of discontinued products, unless within 14 days of purchase. This policy does not affect your statutory rights and does not refer to faulty goods.